

Mozilla Firefox Printing Help

The settings used for printing documents from the Web-based policy system are controlled through the web browser used to access the system (i.e., Google Chrome, Mozilla Firefox, etc.).

1. To access the print settings, please see the upper, right-hand corner of the Firefox window, and select the Open Menu icon (highlighted in blue below).

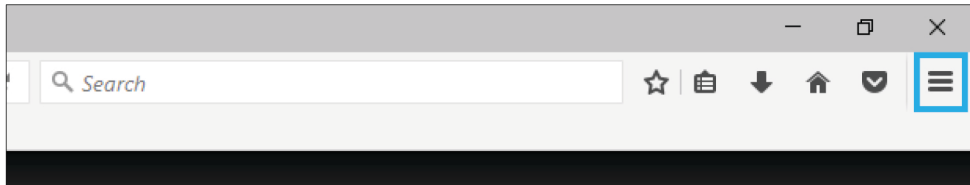

2. Select the Print icon. This will cause a Print Preview window to open. In the upper, left-hand corner of the preview window, select the Page Setup icon. This will open the Page Setup window.

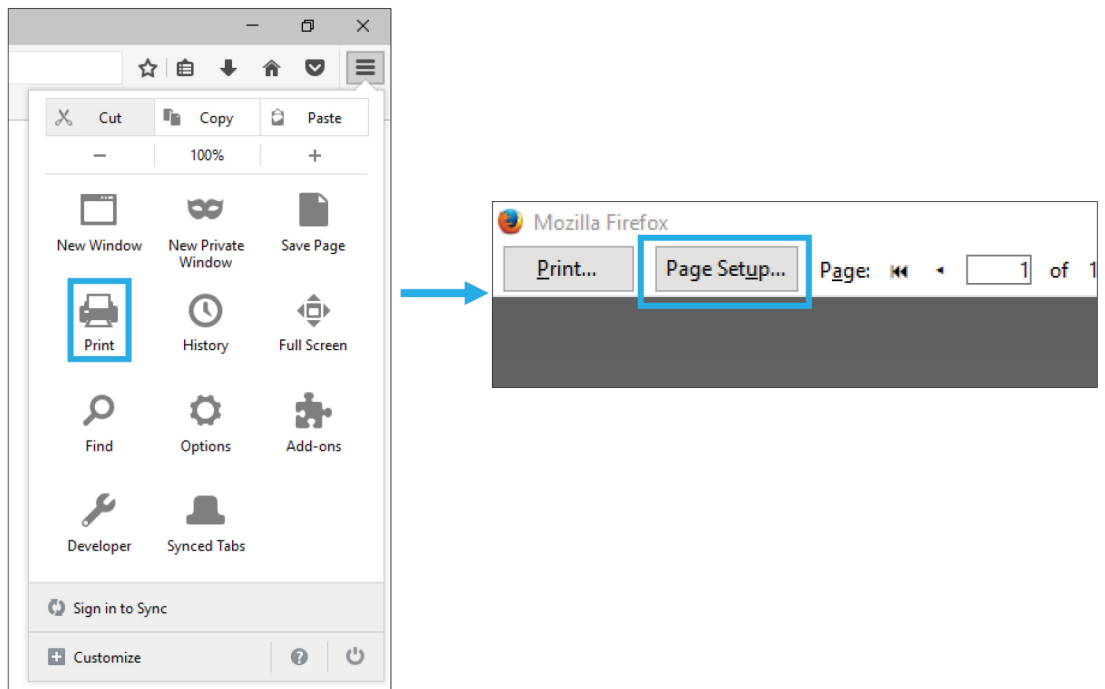

3. Some users may notice that their document changes made using the Tracking Changes function or text color and background color tools are not being printed. To solve this issue, see the Options box, and make sure Print Background is checked.

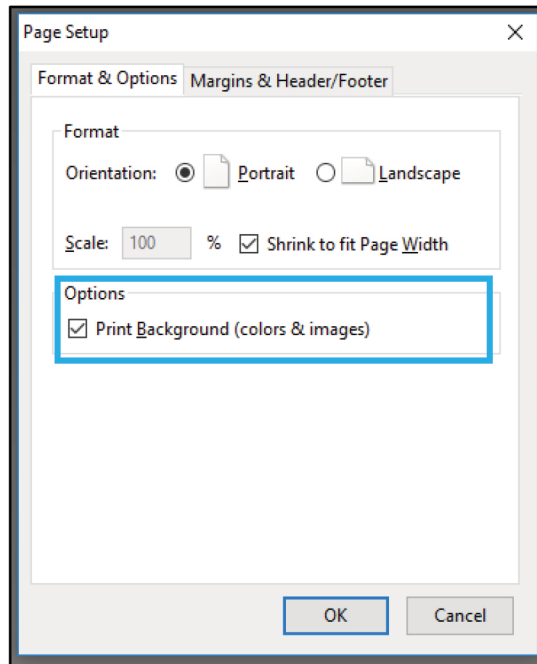

4. If the document language is being partially obstructed by the three-hole punch, please select the Margins & Header/Footer tab of the Page Setup window.

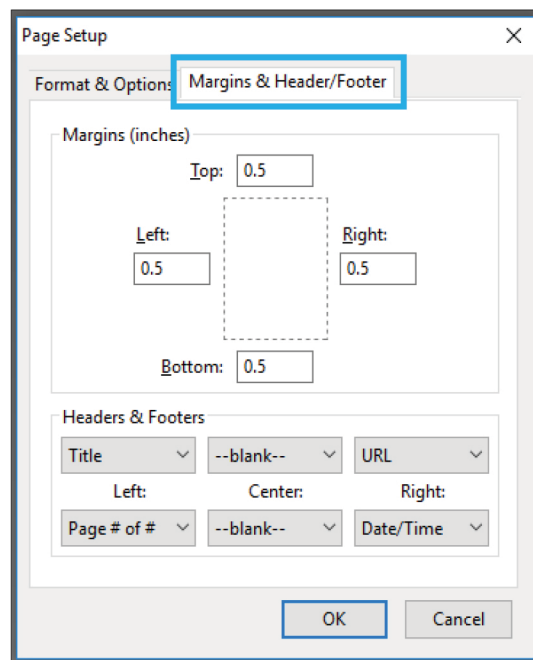

5. By default, the document margins will be set to 0.5 inches on all sides. Different users will find that different margins work best, and the user may need to try different measurements for the left margin. We recommend changing the left margin to 0.6 inches to start.

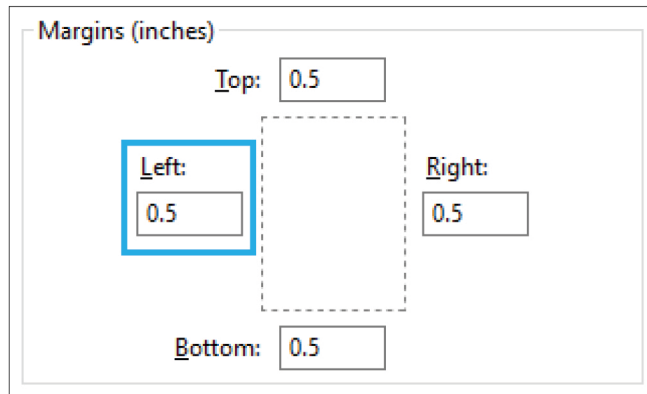

6. Using the Headers & Footers box, the user also can choose what information is included in the document margins. The top row of boxes denotes the header information and the bottom row denotes the footer. In between the rows of boxes are labels noting the orientation of each option.

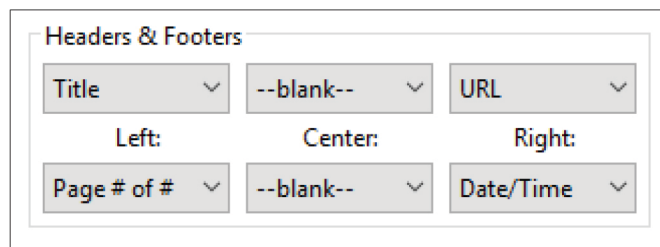

7. By selecting a box, a drop-down menu will appear, allowing the user to select the information desired, including the option to leave the area blank, or to insert custom text. The header and footer selected will be applied to every page that is printed.

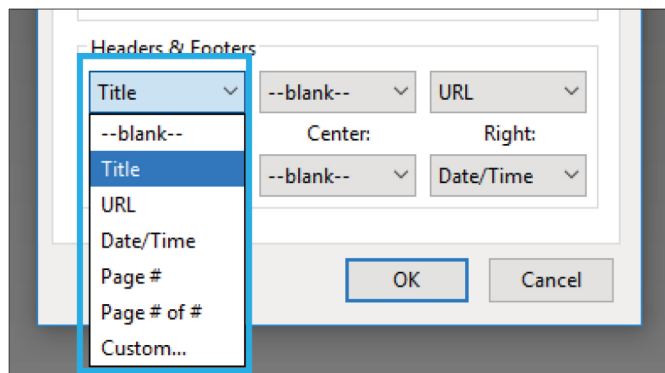

8. When finished, select OK in the Page Setup window. In the Web-based policy system, use the printer icon on the upper, left corner of the desired policy to print the document with the new settings.

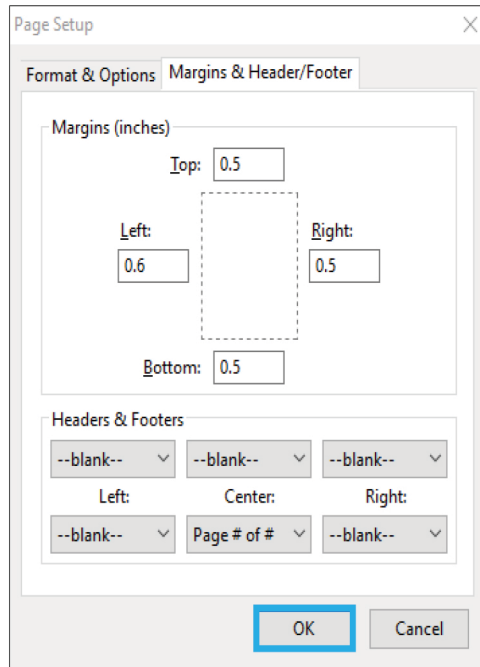

The screenshot shows the web-based policy system interface. On the left, there is a sidebar with a search bar and a list of policies. The '200 Pupils' section is expanded, showing '200 Enrollment in District' selected. On the right, there is a details panel for the selected policy. The printer icon in the top right corner of the details panel is highlighted with a blue box.

Search Active Policies

Book: Policy Manual

Featured

- 000 Local Board Procedures
- 100 Programs
- 200 Pupils

200
Enrollment in District

201
Admission of Students

202
Eligibility of Nonresident Students

203
Immunizations and Communicable Diseases

203.1

Book: Policy Manual

Section: 200 Pupils

Title: Enrollment in District

Number: 200

Status: Active

Adopted: June 14, 2005

Last Revised: November 10, 2009

Authority

The Board shall enroll school age students eligi and regulations, Board policy and administrative